

GAS NOTES:

1. Gas installation to comply with SANS 10087.
2. Bottle(s) can not be placed closer than 1m to a door.
3. Bottle(s) can not be placed closer than 2m to an open drain or Gully.
4. Bottle(s) can not be placed closer than 5m to an electrical switch, motor, generator, pool pump etc.
5. Bottle(s) can not be placed closer than 1m to the side of a window unless there is atleast 300mm between the bottom of the window and the top of the bottle and a non combustible roof has been placed between the window and the bottle.
6. Bottle(s) can not be placed closer than 1m to a boundary wall, unless the wall is a double brick "firewall" > 1.5m tall, with no ventilation gaps in the wall.
7. Only a registered LP gas installer may work on a gas system.
8. Every installation must be signed off by installer with a valid certificate.
9. Copper pipe must be greater than class 1 or 0.7mm wall thickness (copper used for water is class 0) and any copper pipe passing through or embedded in a wall, cement or ground, must be protected with a protective sleeve.
10. Reinforced "orange" hose connecting appliances can not be longer than 2m and the hose can not have any joins and it can not pass through any walls or partition.

DRAINAGE NOTES:

1. ALL DRAINAGE WORK TO BE DONE IN ACCORDANCE WITH NATIONAL BUILDING REGULATIONS.
2. THERE IS TO BE AN INSPECTION EYE TO ALL CHANGES OF DIRECTION AND GRADIENT IN SEWER PIPE.
3. 100/110mmØ PVC SOIL PIPE IN GROUND TO FALL MIN 1:90 & MAX 1:15.
4. 50mmØ WASTE PIPE TO ALL SINKS & WASHTRUGHS.
5. 40mmØ WASTE PIPES TO ALL BATHS AND SHOWERS & WASHING MACHINES.
6. 100/110mmØ SOIL PIPE TO ALL WCs.
7. ALL SEWERS PASSING BELOW A BUILDING TO BE PROTECTED FROM LOAD AND THERE IS TO BE AN INSPECTION EYE AT START AND END OF BUILDING FOUNDATION.
8. ALL VENT PIPES TO FINISH AT LEAST 100mm ABOVE ROOF LEVEL.

STANDARD NOTES

1. PIPES ON SURFACES OTHER THAN IN DUCTS WILL NOT BE ALLOWED.
2. ALL HORIZONTAL PLASTER SURFACES TO BE WATERPROOFED WITH FIBRE-GLASS STRIPS AND ARE TO BE FINISHED WITH A LAYER OF SMOOTH PLASTER AND IS TO SLOPE TO INSIDE TO AVOID DIRT MARKS ON EXTERIOR OF PLASTER AND PAINTED SURFACES.
3. ALL MEASUREMENTS MUST TO BE CHECKED ON SITE BEFORE BUILDING WORK COMMENCES. ANY DISCREPANCIES MUST BE DISCUSSED WITH THE ARCHITECT BEFORE WORK IS CARRIED OUT.
4. ANY DISCREPANCIES TO BE DISCUSSED WITH ARCHITECT BEFORE CONSTRUCTION STARTS.
5. DO NOT SCALE FROM DRAWINGS.
6. ALL PLASTER MUST BE KEPT WET DURING THE CURING PROCESS TO AVOID CRACKS LATER ON.
7. NATURAL GROUND LEVEL TO BE 150mm MIN BELOW UNFINISHED FLOOR LEVEL.
8. ALL BUILT IN CUPBOARDS AND KITCHEN CUPBOARDS MUST BE CONSTRUCTED ACCORDING TO THE LAYOUTS PROVIDED BY SPECIALISTS AND THESE DETAILS TAKE PREFERENCE OVER THE ARCHITECTURAL DRAWINGS.
9. A CEILING HATCH MUST BE PROVIDED TO EACH ROOF SPACE.
10. WALLS BETWEEN HOUSE AND GARAGES MUST BE BUILT HARD UP TO UNDERSIDE OF ROOF TILES TO ACT AS A FIRE WALL.
11. NO COMBUSTIBLE MATERIAL IS ALLOWED TO PASS THROUGH FIRE WALLS. WHERE BATTENS / PURLINS PASS THROUGH FIRE WALLS FOR FIXING OF TILES ETC, PAINTING OF SUCH BATTENS/PURLINS WITH A FIRE RETARDING PAINT HAS BEEN ACCEPTED IN THE PAST.
12. TRUSSES ARE NOT ALLOWED AT ALL TO PASS THROUGH FIRE WALLS. A PRODUCT THAT CAN BE USED FOR PAINTING IS "INTSAY" BY "MICON COATINGS". BATTENS MUST BE PAINTED FOR 800mm ON EITHER SIDE OF CROSSING OF FIRE WALL. THIS COATING CONSISTS OF A BASE COAT AND VINYL TOP COAT.
13. ALTERNATIVE PRODUCTS ARE ALSO AVAILABLE ON THE MARKET.
14. ADEQUATE LIGHTNING PROTECTION TO BE PROVIDED.
15. THE ARCHITECT DOES NOT TAKE RESPONSIBILITY FOR ANY WORK DONE BEFORE DRAWINGS HAVE BEEN APPROVED BY LOCAL AUTHORITY.
16. ALL GLAZING SHALL BE IN STRICT CONFORMANCE WITH GLASS MANUFACTURER'S RECOMMENDATIONS @ ALL IN ACCORDANCE WITH THE NATIONAL BUILDING REGULATIONS PART N, SABS 0137, SABS 0400, SABS 1263 AND AAMSA SELECTION GUIDE FOR SAFETY GLAZING MATERIALS.
17. ALL SAFETY GLAZING MATERIALS (EACH PANEL) SHALL BE PERMANENTLY MARKED AND SUCH MUST BE VISIBLE AFTER GLAZING. PERMANENT MARKINGS MUST BE FOR GLASS CODE 1 - HUMAN IMPACT. TOUGHENED SAFETY GLASS MUST BE USED.
18. ALL GLASS PANELES BELOW 500mm MEASURED FROM FLOOR MUST BE SAFETY GLASS.
19. GLASS PANELES MEASURED 1.8m FROM FLOOR ON STAIRCASES MUST BE SAFETY GLAZING.
20. POSITION OF SEWER CONNECTION, WATER CONNECTION, TELECOMS AND ELECTRICAL CONNECTIONS TO BE CHECKED ON SITE BEFORE CONSTRUCTION STARTS.
21. ALL PATIOS AND GARAGE FLOORS TO BE MIN 85mm (170mm PREFERRED) LOWER THAN SURROUNDING HOUSE FLOORS.
22. ALL FINISHES TO BE AS PER SPECIFICATIONS FROM DALMAR CONSTRUCTION.

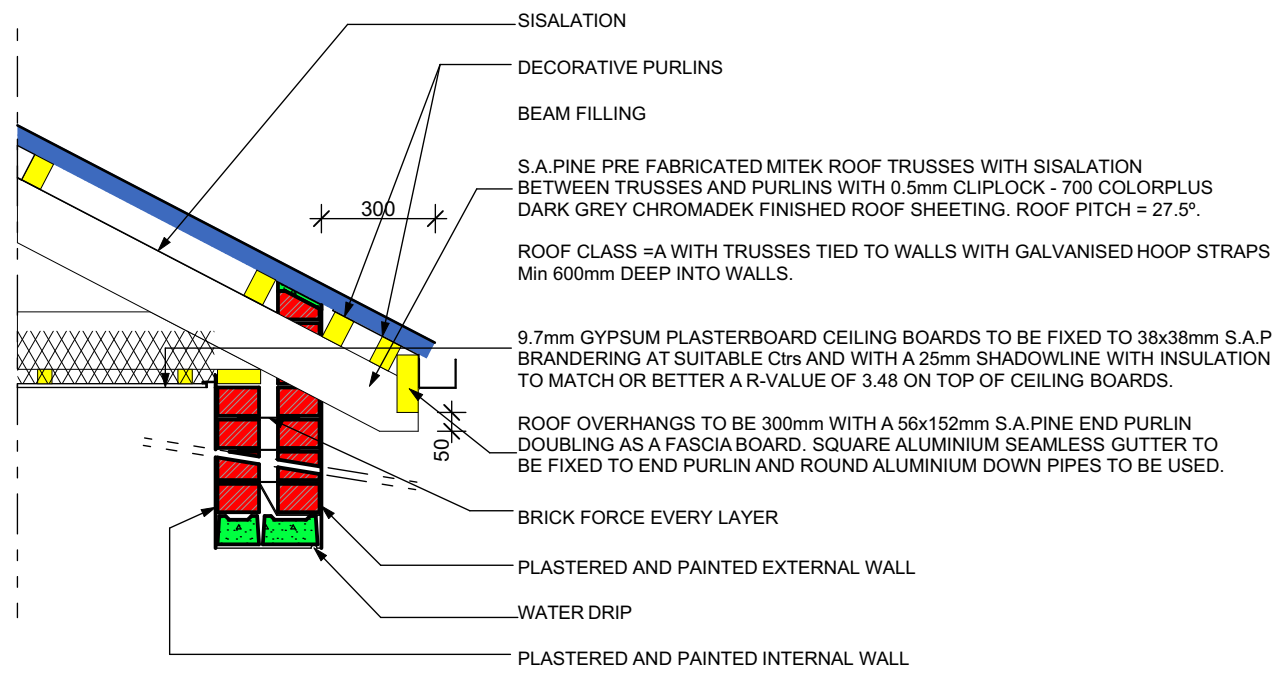

Roof Overhang Detail

1:20

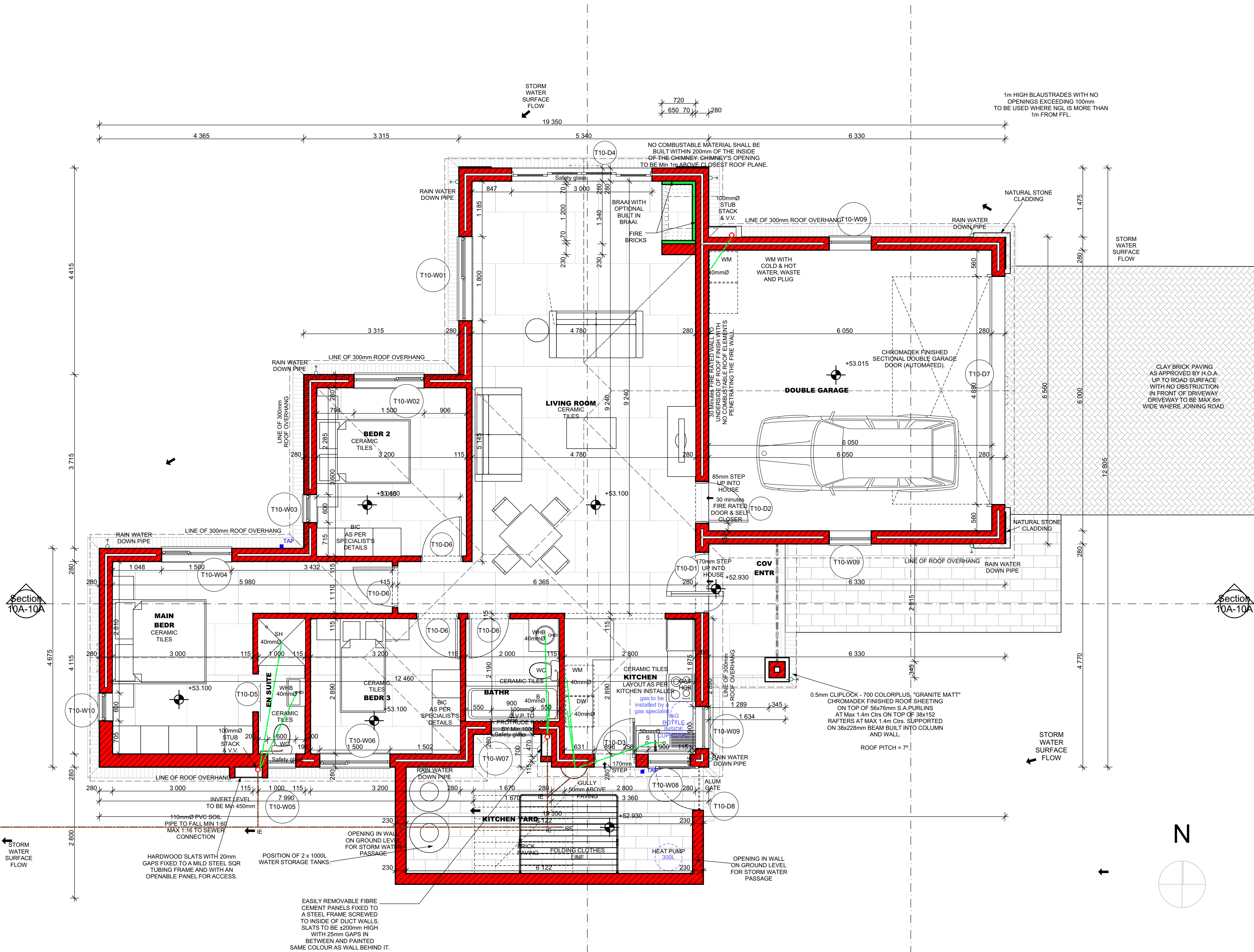

Ground Storey-Unit Type 10A

1:50

AREAS:

MAIN HOUSE AREA -115.4m²
DOUBLE GARAGES - 41.5m²
COVERED ENTRANCE - 4.7m²
TOTAL COV AREAS - 161.6m²

AREA OF STAND - XXXm²
COVERAGE - XXX%
F.A.R. - XXX

REVISIONS:

- A JUN'21 CHANGED TO REV A TO ESTABLISH A REFERENCE POINT
- B JUL'21 MINOR CHANGES TO KITCHEN LAYOUT.
- C SEP'21 KITCHEN YARD CHANGED TO ACCOM TANKS.
- D OCT'24 DOORS CHANGED, LIGHTS ADDED.
- E AUG'25 COV ENTR ENLARGED.
- F OCT'25 CLADDING ADDED, ENTR REVISED.

TCS Architectural Design cc
thinus smuts
Professional Senior Architectural Technologist
Reg. No: S13391
tsmuts@telkomia.net
082 337-1384 (cell)
082 131 337 1384 (fax)
011 894-5877 (fax)
www.tcs-architects.co.za

PROJECT NAME:

Proposed New House in
Hartenbos, Hartland Lifestyle
Estate.

DRAWING NAME:

Ground Storey-Unit Type 10A,
Drainage Notes, Gas Notes,
Standard Notes, Roof Overhang
Detail

Drawing Status	Unit Type 10A
Drawn by Thinus Smuts	Date
Owner's Signature	Date
Drawing Scale	1:50, 1:100, 1:20
Project Number: 2020/005	This drawing must be printed on A1 size paper to be to scale.
Layout ID T10(F)-100	Status Revision F